

acer
explore beyond limits™

Liquid | Z3



Acer Liquid Z3 User's Manual

Model: Z130

This revision: 7/2013

Acer Liquid Z3 Smartphone

Model number: _____

Serial number: _____

Date of purchase: _____

Place of purchase: _____

Table of contents

Table of contents	3
Setting up	5
Unpacking your smartphone	5
Getting to know your smartphone	5
Installing or removing the battery	6
Installing a SIM or microSD Card	7
Using your smartphone	9
Turning on for the first time	9
Locking your smartphone	9
Navigating through menus and options	10
Using the touchscreen	11
The Home screen	13
Multitasking	19
Managing contacts	20
Managing your contacts	20
Making calls	21
Before making a call	21
Making a call	21
The voice call screen	22
Messaging	25
Creating a new message	25
Replying to a message	25
MMS messages	26
Going online	28
Browsing the Internet	28
Setting up your Google email	29
Composing an email	29
Setting up Email	29
Maps, Navigation, Places and Latitude	31
Using the Camera	32
Camera icons and indicators	32
Taking a photo	34
Shooting a video	34
Viewing photos and videos	34

Geotagging	35
Advanced settings - - - - -	36
Changing modes with QuickMode	36
Putting your smartphone in Airplane mode	37
Restarting your phone	37
Adjusting settings	38
Connecting to a PC	41
FM radio	42
Multimedia playback	42
Restoring to factory settings	43
Accessories and tips - - - - -	45
Using the headset	45
Using a Bluetooth headset	45
Inserting a microSD Card	45
Appendix - - - - -	46
FAQ and troubleshooting.	46
Other sources of help	47
Warnings and precautions	47
Emergency calls	49
Taking care of your smartphone	49
Specifications	51
Safety	53
End User License Agreement - - - - -	61

Setting up

Unpacking your smartphone

Your new smartphone comes packed in a protective box. Carefully unpack the box and remove the contents. If any of the following items is missing or damaged, contact your dealer immediately:

- Acer Liquid Z3 Smartphone
- Battery
- Quick Guide
- USB cable
- AC adapter
- Headset



Note: In-box content varies depending on country and region.

Getting to know your smartphone

Views

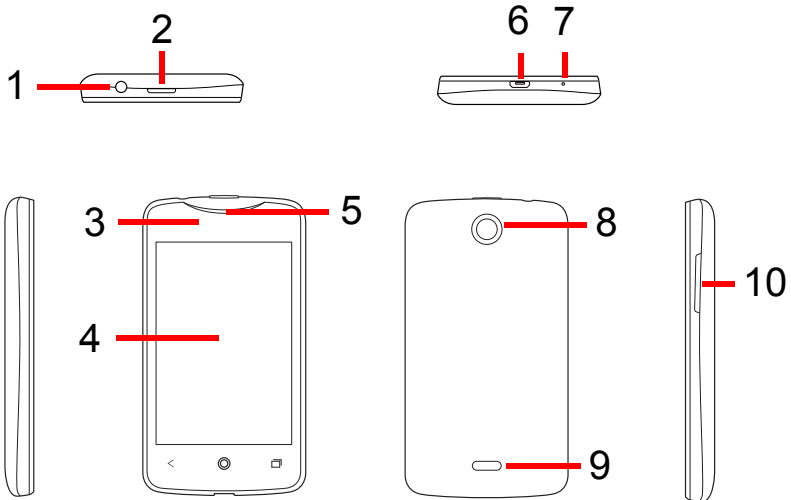

No.	Item	Description
1	3.5 mm headphone jack	Connects to stereo headphones.
2	Power button	Press to turn the screen on/off or enter sleep mode; press and hold to turn the smartphone on or off.
3	LED indicator	Indicates the phone's charging status.

No.	Item	Description
4	Touchscreen	3.5-inch, 320 x 480 pixel capacitive touchscreen to display data, phone content and enter information.
5	Phone speaker	Emits audio from your smartphone; suitable for holding to your ear.
6	Micro USB connector	Connects to a USB cable/charger.
7	Microphone	Internal microphone.
8	Camera	A camera for taking high-resolution images.
9	Handsfree stereo speakers	Emit stereo audio from your smartphone; suitable for handsfree use.
10	Volume up/down buttons	Increases or decreases the phone volume.

LED Indicators

Status	Description
Red	Charging.

Installing or removing the battery

Your smartphone uses a replaceable battery to provide power. It is packed separately from your smartphone and needs to be inserted and charged before you can use the smartphone.

Installing the battery

Insert your fingernail into the micro USB port between the battery cover and the phone. Put fingers on the middle of the battery cover for leverage. Unclip the cover with your fingernail and lift it off the phone.

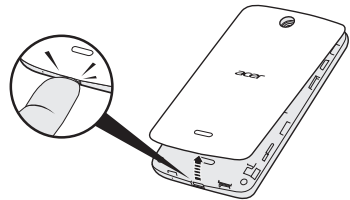

Place the battery into the battery compartment, lining up the battery connectors with those at the bottom of the compartment.

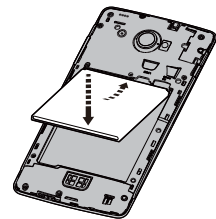

Align the tabs on the cover into the slots on the phone. Gently press the cover until it snaps in place.

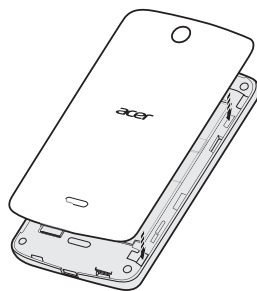

**CAUTION: RISK OF EXPLOSION IF BATTERY IS REPLACED BY AN INCORRECT TYPE.
DISPOSE OF USED BATTERIES ACCORDING TO THE INSTRUCTIONS.**

Charging the battery

For initial use, you need to charge your smartphone for eight hours. After that you can recharge the battery as needed.

Connect the AC adapter cord to the micro USB connector on your smartphone.

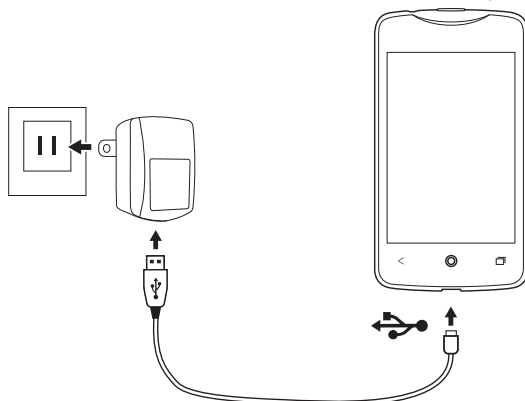

Removing the battery

Open the battery compartment as shown in **"Installing the battery"** on page 6. Lift the battery out of the compartment by lifting at the bottom of the battery.

Replace the battery cover as described above.

Installing a SIM or microSD Card

To take full advantage of your smartphone's telephony capabilities, you must install a SIM card. The SIM card holder is located at the top of the battery bay.

Additionally, you may wish to increase your smartphone's storage by inserting a microSD Card into the slot provided.

1. Turn off the phone by pressing and holding the **Power** button.
2. Open the cover and remove the battery as described in "**Removing the battery**" on page 7.
3. Insert the SIM and/or microSD Card as shown.
4. Replace the battery and battery cover.

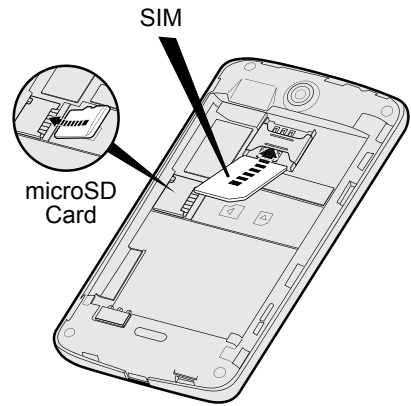

Note: Ensure that the microSD Card is inserted all the way into the card slot.

SIM card lock

Your smartphone may come with a SIM card lock, i.e., you will only be able to use the SIM card provided by your network operator. To cancel the SIM lock, contact your network provider.

Using your smartphone

Turning on for the first time

To turn on your smartphone for the first time, press and hold the **Power** button until the screen turns on. You will then be asked to configure some settings before you can use your smartphone.

Follow the onscreen instructions to complete setup.

Sign in to or create a Google account

If you have Internet access, your smartphone allows you to synchronize information with a google account.

During the start-up process, you may create or sign in to your account, which will be used to synchronize your contact list, email, calendar and other information. If you do not yet have Internet access, or do not want to use this feature, then tap **Skip**.

Creating multiple Google accounts

You can create and easily access multiple Google accounts. Open the **Application** menu and then tap **Settings > Add account**.

Entering your PIN

When you install a SIM card for the first time, you may need to enter a PIN using the onscreen number pad.



.....
Important: Depending on your settings, you may be required to enter your PIN each time you switch on the phone function.
.....

Activating a new SIM card

If you are using your SIM card for the first time, it may require activation. Contact your network operator for details on how to do this.

Locking your smartphone

If you will not use your smartphone for a while, briefly press the **Power** button to lock access. This saves power and ensures your smartphone does not unintentionally use any services. Your smartphone will lock automatically if it is not used for one minute.

Waking your smartphone

If the screen is off and the smartphone does not react to any taps on the screen or front panel buttons, then it has been locked and is in sleep mode.

Press the **Power** button to wake your smartphone. Unlock your smartphone by sliding your finger across the screen (it works both ways).

The lock screen extends to either side of the screen, giving you room to add widgets for quick access. To view the extended lock screen, swipe in from the edge of the display.

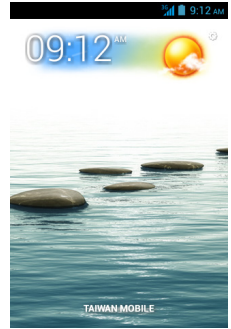

Note: If you access the extended lock screen by accident while trying to unlock the screen, you can disable it by tapping the lock icon at the bottom of the screen. Then, unlock your smartphone as described above.

For additional security, you may set an unlock pattern, a set of dots that must be touched in the correct order to access the phone. Open the **Application** menu and then tap **Settings > Security > Screen lock**.



Note: If you forget your unlock pattern, please refer to "**Unlock pattern**" on page 47.

Navigating through menus and options

To navigate through menus and options, there are three buttons beneath the screen.



Back



Home



Recent

Back

Tap this button to go to the previous page, hide the keyboard, or to go up one level in a menu.

Home

Tap this button to go directly to the Home screen. Tap and hold this button to open the *Search* function. You can also get the *Google Now* app by tapping Get Google Now.



Note: For information on *Google Now*, you may wish to view the Wikipedia page for the app at http://en.wikipedia.org/wiki/Google_Now.

Recent

Tap this button to see recently opened applications. Tap an application to open it, or tap anywhere on the screen to return to the Home screen. See "**Multitasking**" on page 19. Tap and hold this button to display a list of functions enabling you to adjust certain settings.