

vtech®

User's Manual

Go!Go! Smart Wheels®
Playtime with miles of learning!

Ultimate Amazement Park Playset™

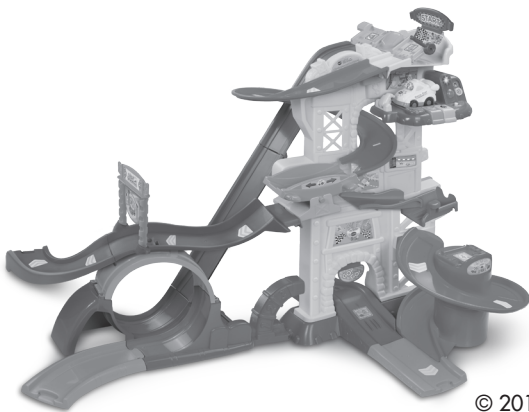

© 2014 VTech
Printed in China
91-002921-002 US

Dear Parent,

Welcome to the world of **Go! Go! Smart Wheels**®! We're excited you've decided to ride along with us and explore all that **Go! Go! Smart Wheels**® has to offer. These toys have been designed to give your child a thrilling learning experience with hours and hours of fun as well.

Go! Go! Smart Wheels® features vehicles that interact with your child by lighting up, singing and talking, while teaching your child letters and vehicle names (each sold separately). There are other surprises in store, too! With our innovative **SmartPoint**™ technology, available exclusively on **Go! Go! Smart Wheels**® playsets (each sold separately), your child will smile as they hear **SmartPoint**™ vehicles respond to each unique **SmartPoint**™ location with singing, sound effects and fun phrases.

Our **Go! Go! Smart Wheels**® playsets also feature buttons, gears and other mechanical features to encourage the development of your child's fine motor skills. Many of the playsets also have tracks that can be arranged in endless ways, stimulating your child's creativity. In addition, many of the **Go! Go! Smart Wheels**® playsets connect to other playsets in the collection, so there's no end to what your child can do!

With **Go! Go! Smart Wheels**®, it's playtime with miles of learning!

Sincerely,
Your friends at **VTech**®

To learn more about **VTech**® toys, visit www.vtechkids.com

INTRODUCTION

Thank you for purchasing the **VTech® Go! Go! Smart Wheels® Ultimate Amusement Park Playset™** learning toy!

Pull the flag and zoom around obstacles with the **Go! Go! Smart Wheels® Ultimate Amusement Park Playset™** by **VTech®**! Develop language and motor skills while racing through three incredible features including a 360 degree loop, spiral and ramp!

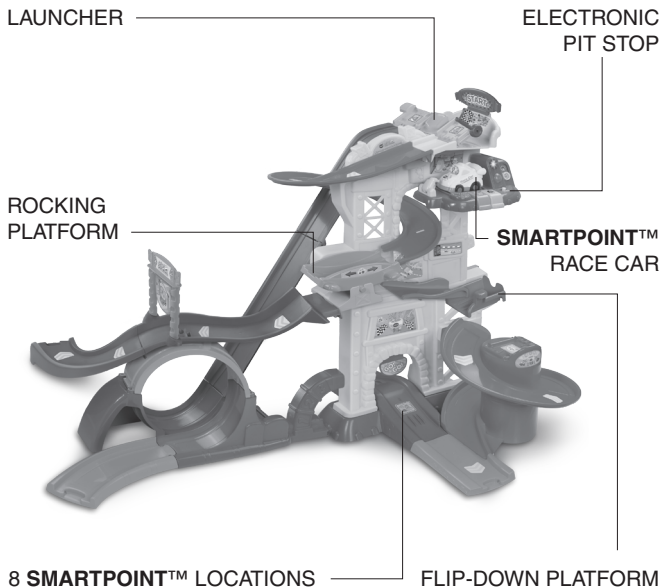

INCLUDED IN THIS PACKAGE



One **SmartPoint™**
race car



One **SmartPoint™**
electronic pit stop



One **SmartPoint™**
tower base

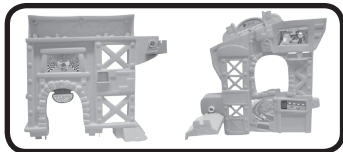

Two tower pieces



One **SmartPoint™**
launcher



Two C-shaped tracks

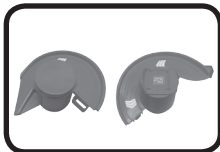

Two spiral tracks with
SmartPoint™ platform



One **SmartPoint™**
loop base



Two long straight tracks



Two ramp tracks



One semicircular
loop track

Included In This Package



- One base support
- One rocking platform
- One flip-down **SmartPoint™** platform
- One mini ramp track
- One short curved track
- One short straight track

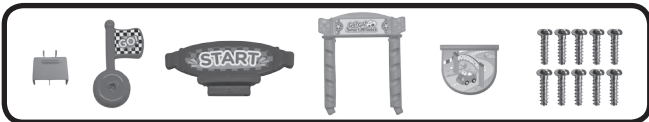

- One small track support
- One flag piece
- One start sign
- One gate
- One flipping board
- 10 screws



- Two label sheets
- One user's manual

Included In This Package

WARNING:

All packing materials, such as tape, plastic sheets, packaging locks and tags are not part of this toy, and should be discarded for your child's safety.

ATTENTION:

Pour la sécurité de votre enfant, débarrassez-vous de tous les produits d'emballage tels que rubans adhésifs, feuilles de plastique, attaches et étiquettes. Ils ne font pas partie du jouet.

NOTE:

Please keep this user's manual as it contains important information.



CAUTION:

Adult assembly required. This package contains small screws. For your child's safety, do not let your child play with the toy until it is fully assembled.

GETTING STARTED

BATTERY INSTALLATION – RACE CAR

1. Make sure the unit is turned **OFF**.
2. Locate the battery cover on the bottom of the race car. Use a coin or a screwdriver to loosen the screw.
3. Install 2 new “AAA” (AM-4/LR03) batteries following the diagram inside the battery box. (The use of new alkaline batteries is recommended for maximum performance.)
4. Replace the battery cover and tighten the screw to secure the battery cover.

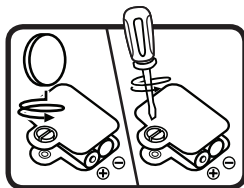

BATTERY INSTALLATION – ELECTRONIC PIT STOP

1. Make sure the unit is turned **OFF**.
2. Locate the battery cover on the right side of the electronic pit stop. Use a screwdriver to loosen the screw.
3. Install 2 new “AAA” (AM-4/LR03) batteries following the diagram inside the battery box. (The use of new alkaline batteries is recommended for maximum performance.)
4. Replace the battery cover and tighten the screw to secure the battery cover.

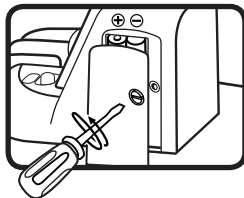

BATTERY NOTICE

- Use new alkaline batteries for maximum performance.
- Use only batteries of the same or equivalent type as recommended.
- Do not mix different types of batteries: alkaline, standard (carbon-zinc) or rechargeable (Ni-Cd, Ni-MH), or new and used batteries.
- Do not use damaged batteries.
- Insert batteries with the correct polarity.
- Do not short-circuit the battery terminals.
- Remove exhausted batteries from the toy.
- Remove batteries during long periods of non-use.
- Do not dispose of batteries in fire.
- Do not charge non-rechargeable batteries.
- Remove rechargeable batteries from the toy before charging (if removable).
- Rechargeable batteries are only to be charged under adult supervision.

Please adhere the labels to the playset securely as indicated below:

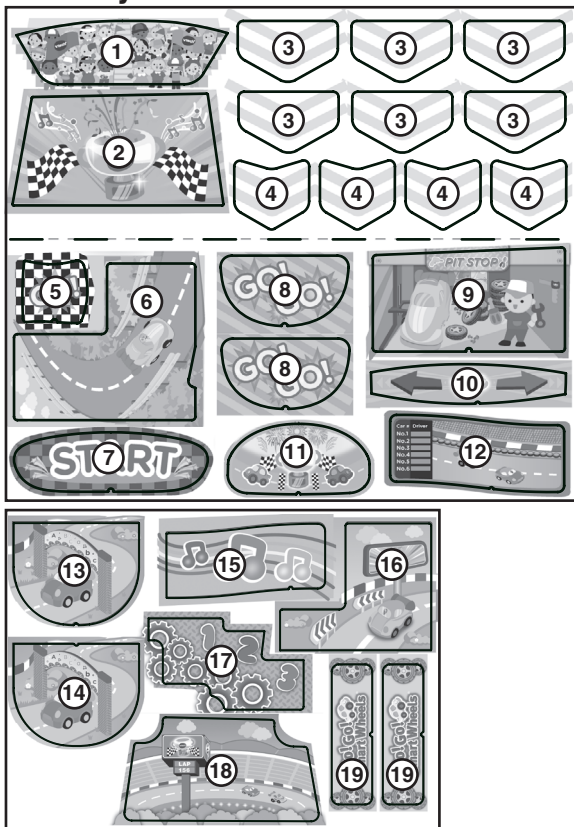

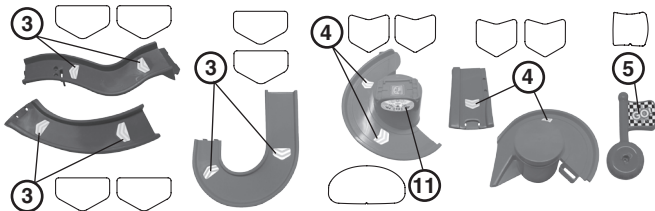
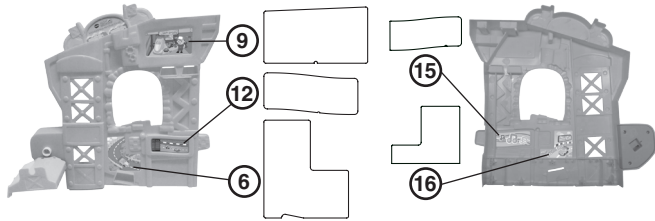
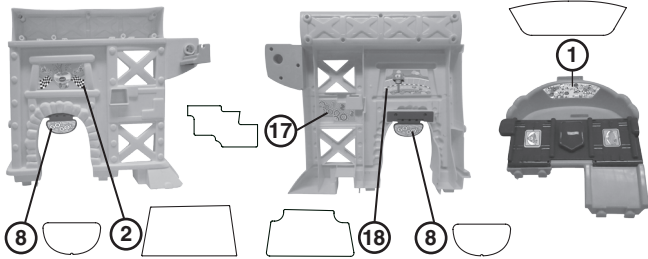

Label Instructions

ASSEMBLY INSTRUCTIONS

With the VTech® Go! Go! Smart Wheels® Ultimate Amazement Park Playset™, safety comes first. To ensure your child's safety, adult assembly is required. You will need a Phillips head screwdriver to assemble the playset (not included).

Assemble the Tower

1. Insert the big tower piece with the archway on the bottom into the slots on the tower base. Then turn the pieces upside-down and push down firmly until the pieces “click” into place. Insert the second big tower piece into the slots located on the top of the first tower piece. Use a screwdriver to fasten seven screws into the holes on the back of the lower tower piece.

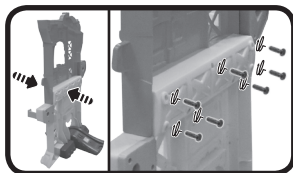
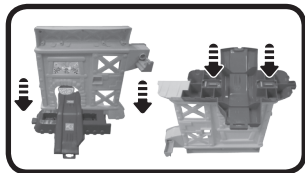

2. Attach the flag to the launcher using a screw. Then insert the launcher into the slots on the top of the fully assembled tower piece. You should hear a “click” sound to indicate that the pieces are secure.

