

GUIDE | GUIDE | GUÍA



# IMPORTANT SAFEGUARDS

When using electrical appliances, basic safety precautions should be followed, including the following:

1. Read all instructions before using.
2. Do not touch hot surfaces. Use handles and knobs when available.
3. This appliance must be properly installed and located in accordance with these instructions before it is used.
4. The use of accessory attachments not recommended by the appliance manufacturer may result in fire, electrical shock or injury to persons.
5. Do not place on or near a hot gas or electric burner, or in a heated oven.
6. Do not use outdoors.
7. To protect against fire, electric shock and injury do not immerse cords, plugs or the appliance in water or any other liquid.
8. Do not fill the Water Reservoir above the MAX FILL line.
9. **Use only water in this appliance!** Do not put any other liquids or foods in the Water Reservoir except as instructed in the cleaning instructions in this guide.
10. Turn off and unplug the brewer before cleaning or maintenance. Allow to cool before putting on or taking off parts and before cleaning the appliance.
11. For best operation, plug the appliance into its own electrical outlet on a dedicated circuit to prevent flickering of lights, blowing of fuses or tripping a circuit breaker.
12. Do not operate any appliance with a damaged Power Cord or plug or after the appliance malfunctions or is damaged in any manner. Contact Keurig Customer Service to report any malfunction of or damage to the brewer.
13. Do not let the Power Cord hang over the edge of the table or counter, or touch hot surfaces.
14. To disconnect, press the Power Button on the brewer to "OFF" status and then remove the plug from the wall outlet.
15. Close supervision is necessary when any appliance is used by or near children.
16. **Do not lift the brewer Handle while brewing is in progress.**
17. Always keep the Flip-Top Reservoir Lid on the Water Reservoir unless you are refilling it.
18. This appliance is equipped with a Power Cord having a grounding wire with a grounding plug. The appliance must be grounded using a 3-hole properly grounded outlet. In the event of an electrical short circuit, grounding reduces the risk of electrical shock.
19. If the outlet is a standard 2-prong wall outlet, it is your personal responsibility and obligation to have it replaced with a properly grounded 3-prong wall outlet.
20. Do not, under any circumstances, cut or remove the third (ground) prong from the Power Cord or use an adapter.
21. Consult a qualified electrician if the grounding instructions are not completely understood, or if doubt exists as to whether the appliance is properly grounded.
22. Do not use the appliance for other than its intended use.
23. Remove the shipping disk before brewing.

## SAVE THESE INSTRUCTIONS.

### WARNING TO USERS AND PARENTS:

1. **DO NOT** permit children to use the brewer unless there is adult supervision. Brewer dispenses very hot water.
2. **SPECIAL NOTICE FOR HOT COCOA/OTHER USERS: IMMEDIATELY AFTER USING A HOT COCOA/OTHER PACK, RUN A HOT WATER BREW CYCLE** without a pack to avoid the possibility of clogging the exit needle. **DO NOT** assume the next user will do this.

## WARNING



WARNING: TO REDUCE THE RISK OF FIRE OR ELECTRIC SHOCK, DO NOT REMOVE THE BOTTOM COVER. NO USER SERVICEABLE PARTS ARE INSIDE. REPAIR SHOULD BE DONE BY AUTHORIZED SERVICE PERSONNEL ONLY.

**CAUTION:** There are three sharp needles that puncture packs, two above the Pack Holder and the other in the bottom of the Pack Holder. To avoid risk of injury, do not put your fingers in the Pack Holder Assembly.

**CAUTION:** There is extremely hot water in the Pack Holder during the brew process. To avoid risk of injury, do not lift the Handle or open the Pack Holder Assembly during the brewing process.

**CAUTION:** Do not fill above the MAX FILL line. If you fill the Water Reservoir above this point, you may occasionally get a larger brew than you selected for your first brew of the day. If you prefer to have your Water Reservoir filled to the top, we recommend you use a large mug for your first brew of the day to avoid any risk of overflow.

**CAUTION:** Please always keep the brewer in its upright position to avoid potential injury and/or damage to your brewer.

**CAUTION:** Very hot liquid. Adult supervision required.

**SHORT CORD INSTRUCTIONS:**

A short power supply cord is provided to reduce the risk of becoming entangled in or tripping over a longer cord.

Longer detachable power-supply cords or extension cords are available and may be used if care is exercised in their use. If an extension cord is used, (1) the marked electrical rating of the cord set or extension cord should be at least as great as the electrical rating of the appliance; (2) the cord should be arranged so that it will not drape over the countertop or tabletop where it can be pulled on by children or tripped over unintentionally; and (3) the extension cord must include a 3-prong grounding plug.

**Your Keurig® 2.0 brewer will not work with packs that do not have the Keurig® logo on them.**

**Keurig® 2.0 brewers are not compatible with the My K-Cup® reusable filter accessory.**

**THIS PRODUCT IS FOR HOUSEHOLD USE ONLY.**

## **WARNING**

**THIS PRODUCT CONTAINS CHEMICALS, INCLUDING LEAD, WHICH IS KNOWN TO THE STATE OF CALIFORNIA TO CAUSE CANCER, BIRTH DEFECTS OR OTHER REPRODUCTIVE HARM.**

## **TABLE OF CONTENTS**

**KEURIG® 2.0 BREWING SYSTEM | K2.0-500 SERIES BREWER**

|                                 |    |
|---------------------------------|----|
| Features                        | 6  |
| Touchscreen Controls            | 7  |
| <b>SECTION 1</b>                |    |
| Set-Up & Cleansing Brew         | 8  |
| Brew Your First K-Cup® Pack     | 10 |
| Brew Your First K-Carafe™ Pack  | 11 |
| Set Carafe Auto Brew Mode       | 12 |
| <b>SECTION 2</b>                |    |
| Stopping the Brew Process       | 14 |
| Adding Water                    | 14 |
| Dispensing Hot Water into a Mug | 15 |
| Adding a Favorite               | 16 |
| Editing a Favorite              | 17 |
| Using a Favorite                | 17 |
| Settings Menu                   | 18 |
| Caring For Your Brewer          | 23 |
| Maintenance Alerts              | 28 |
| Recycling K-Carafe™ Packs       | 31 |
| <b>SECTION 3</b>                |    |
| Troubleshooting                 | 32 |
| <b>SECTION 4</b>                |    |
| Warranty                        | 34 |

## FEATURES



### K2.0-500 SERIES BREWER

- A. Flip-Top Reservoir Lid
- B. Water Reservoir
- C. Top Housing
- D. Touchscreen/Power Button
- E. Brew Button
- F. Handle
- G. Brew Head
- H. Power Cord
- I. Drip Tray Plate
- J. Drip Tray
- K. Pack Holder
- L. Housing (K and L are the Pack Holder Assembly)
- M. Base
- N. Keurig™ Carafe

## TOUCHSCREEN CONTROLS

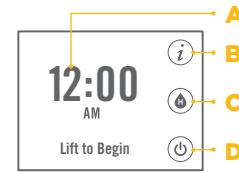

### HOME SCREEN

- A. Clock
- B. Settings Button
- C. Hot Water Button
- D. Power Button

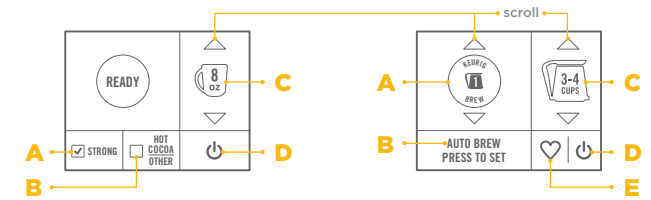

### SCREEN FOR K-CUP® PACKS

- A. STRONG (only available for coffee)
- B. HOT COCOA/OTHER (for select non-coffee beverages)
- C. Brew Size
- D. Power Button

### SCREEN FOR K-CARAFE™ PACKS

- A. KEURIG BREW® Setting 1
- B. AUTO BREW (only available for K-Carafe™ packs)
- C. Brew Size
- D. Power Button
- E. Favorites Button

### BREW SETTINGS (OUTLINE INDICATES DEFAULT SIZE)

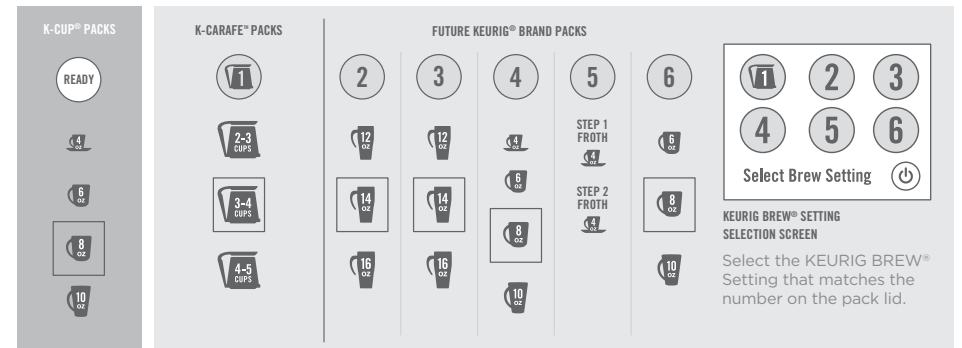

## SET-UP

1. Place the brewer on a counter and plug into a grounded outlet.

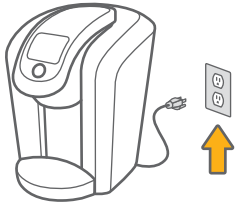

2. Lift the Handle, remove and discard the shipping disk.

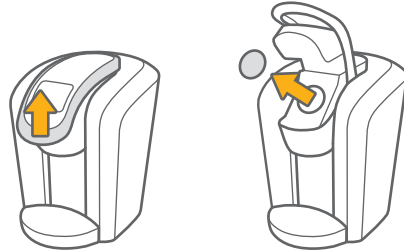

3. Rinse the Water Reservoir, fill with bottled or filtered water, and return it to the brewer.

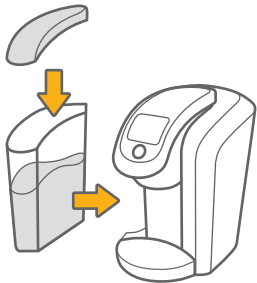

4. Press the Power Button and wait for preheating to complete, about three minutes.

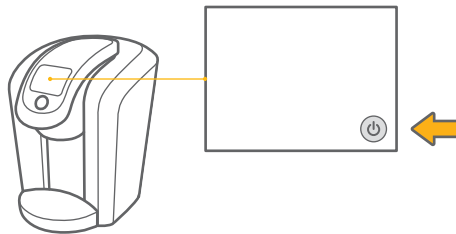

## CLEANSING BREW

1. To begin a cleansing brew, place a 12 ounce mug on the Drip Tray.



2. Lift and lower the Handle. Do not place a Keurig® brand pack in the Pack Holder.

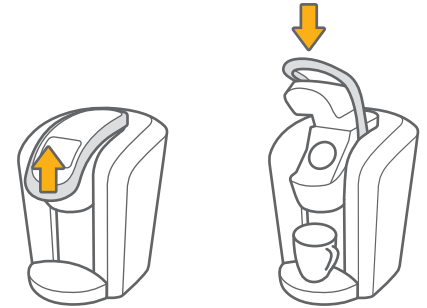

3. Hold down the Brew Button until 6 ounces of hot water has been dispensed. The brewer will automatically stop dispensing after 6 ounces.



4. You are now ready to use your brewer!



# BREW YOUR FIRST K-CUP® PACK

- Place a mug on the Drip Tray. Select a K-Cup® pack, place firmly in the Pack Holder.

NOTE: Do not remove the foil lid or puncture the K-Cup® pack.

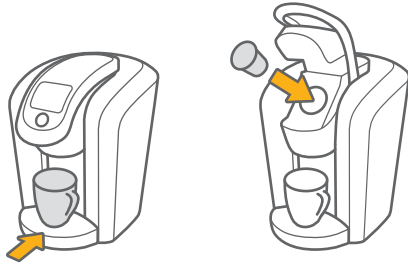

- Lower the Handle.

CAUTION: There are sharp needles that puncture the K-Cup® pack above and below the Pack Holder. To avoid injury, do not put your fingers in the Pack Holder.

NOTE: Your Keurig® 2.0 brewer will not work with packs that do not have a Keurig® logo on them.

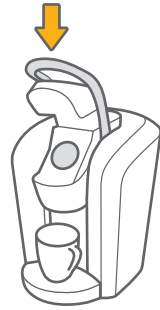

- Select a Brew Size. Select STRONG if desired. (STRONG setting is for coffee.)



Press HOT COCOA/OTHER for select non-coffee beverages.

NOTE: Make sure to check instructions on portion pack packaging.



- Press the Brew Button and enjoy your first cup!

CAUTION: There is extremely hot water in the K-Cup® pack during the brew process. To avoid injury, do not lift the Handle during the brew process.



# BREW YOUR FIRST K-CARAFE™ PACK

## SECTION 1

- Make sure the Keurig™ Carafe is empty. Remove the Drip Tray and insert the Keurig™ Carafe securely in its place.

NOTE: Do not remove the foil lid or puncture the K-Carafe™ pack.

NOTE: Refer to page 27 for Keurig™ Carafe operation.

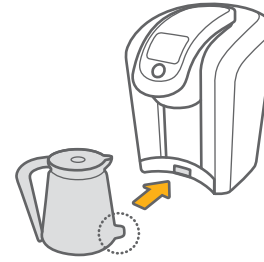

- Select a K-Carafe™ pack, place firmly in the Pack Holder and lower the Handle.

CAUTION: There are sharp needles that puncture the K-Carafe™ pack above and below the Pack Holder. To avoid injury, do not put your fingers in the Pack Holder.

NOTE: Your Keurig® 2.0 brewer will not work with packs that do not have a Keurig® logo on them.

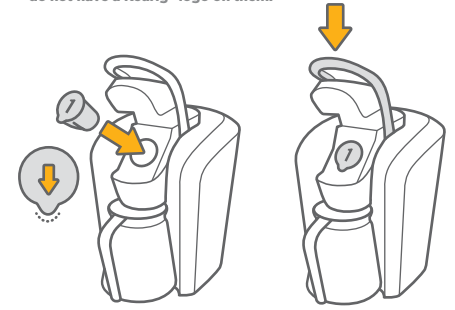

- Select a Brew Size.

NOTE: Make sure the number on the Touchscreen matches the number of the K-Carafe™ pack you're brewing in the Pack Holder.



- Press the Brew Button and enjoy your first carafe of coffee!

CAUTION: There is extremely hot water in the K-Carafe™ pack during the brew process. To avoid injury, do not lift the Handle during the brew process.

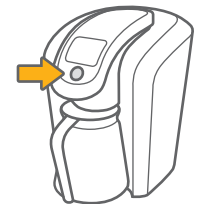

# SET CARAFE AUTO BREW MODE

1. Make sure the Keurig™ Carafe is empty. Remove the Drip Tray and insert the Keurig™ Carafe securely in its place.



2. Select a K-Carafe™ pack, place firmly in the Pack Holder and lower the Handle.  
NOTE: Ensure the current time is accurate. Refer to page 19 to adjust.

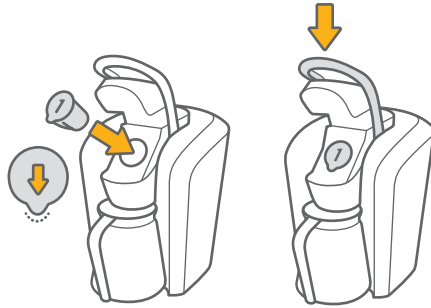

5. Select a Brew Size, then press SET.

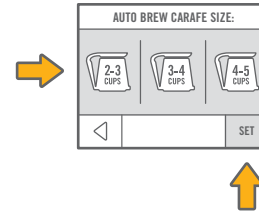

6. The Touchscreen will indicate DO NOT DISTURB!



3. Select AUTO BREW PRESS TO SET.

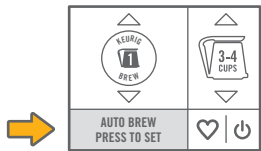

4. Select the time you want to begin brewing, then press the right arrow.

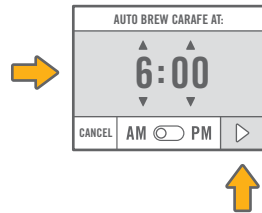

7. To edit any options, select TOUCH HERE TO EDIT.



8. To put the brewer in sleep mode, quickly press and release the Power Button. Removing the Keurig™ Carafe or lifting the Handle will cancel the CARAFE AUTO BREW MODE.



## STOPPING THE BREW PROCESS

### FOR K-CUP® PACKS AND K-CARAFE™ PACKS (KEURIG BREW® SETTING 1)

To stop the brewing process, press and hold the Power Button for one second or slowly lift the Handle. Remove and dispose of any used pack. Brewing a used pack is not recommended.

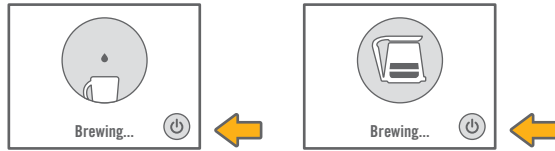

## ADDING WATER

Your Keurig® 2.0 brewer will indicate when the water level in the Water Reservoir is low and you will not be able to brew. The brewer will only indicate “More Water Please.” if there is not enough to complete your brew.

**For example:** A Keurig™ Carafe will require more water than a 10 ounce mug.

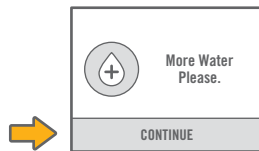

## DISPENSING HOT WATER INTO A MUG

## SECTION 2

1. Press the Hot Water Button.

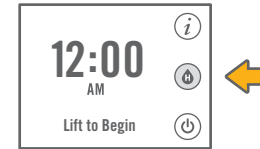

2. Follow the Touchscreen instructions.



3. Press and hold the Brew Button to dispense up to 6 ounces of hot water. The brewer will stop dispensing after 6 ounces.



4. When the brew process is complete, the Touchscreen will indicate Enjoy!

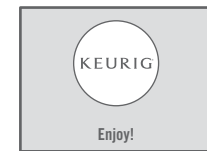



## ADDING A FAVORITE

The Favorites Button is like a little shortcut to perfection. Just save the settings you use most often and make each day that much easier. You can save your preferred settings for K-Carafe™ packs and future Keurig® brand innovations (except K-Cup® packs).

1. To set, first match the KEURIG BREW® Setting to the number on the pack you inserted. Then select your favorite options for size and strength (not available for all KEURIG BREW® Settings). Do not press the Brew Button, press the Favorites Button.

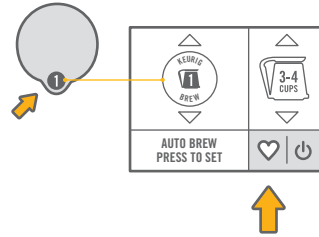

2. Choose one of the three FAVORITES icons to save your favorite.

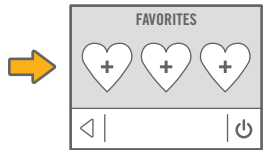

Press YES to confirm.



3. Press a FAVORITES icon and the Touchscreen will indicate the settings for this favorite.



## EDITING A FAVORITE

## SECTION 2

1. Press the Favorites Button and select EDIT.

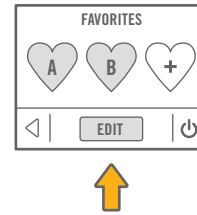

2. Select the FAVORITES icon that you wish to change. Edit the settings and press CONFIRM. Your settings are now changed.

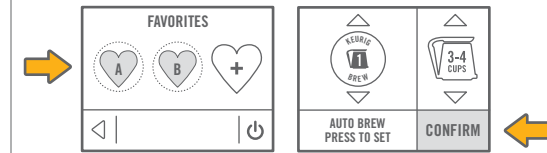

## USING A FAVORITE

1. Place a mug on the Drip Tray. Place a Keurig® brand pack in the Pack Holder and lower the Handle.

NOTE: Favorites is only available for KEURIG BREW® Settings 1 through 6.

NOTE: If using KEURIG BREW® Setting 1, insert the empty Keurig™ Carafe.

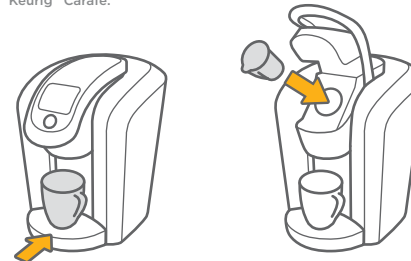

2. Press the Favorites Button and choose the FAVORITES icon you would like to brew.

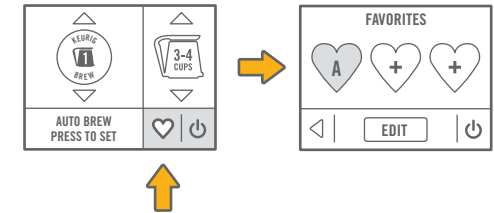

Press the Brew Button.

NOTE: Make sure the selected favorite matches KEURIG BREW® Settings 1 through 6 for the pack you're brewing in the Pack Holder.

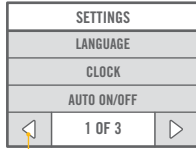
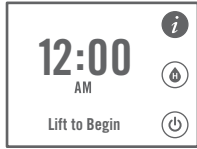

back button

## ACCESS SETTINGS

Explore everything your Keurig® 2.0 brewer has to offer by accessing the SETTINGS menu. From the home screen, select the Settings Button.

Use the arrows to scroll through the menu. To exit, press the back button.

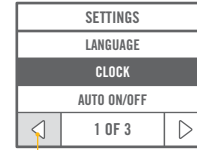

back button

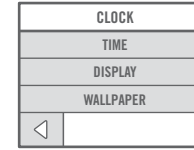

## SET CLOCK

The CLOCK menu gives you the following three settings.

Use the back button to return to the SETTINGS menu.



**Time:** Set the current time using the arrows, then choose AM or PM.

Press SAVE to confirm or use the back button to return to the SETTINGS menu.

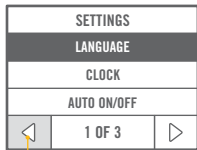

back button

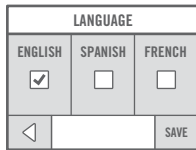

## CHOOSE LANGUAGE

Press English, Spanish or French to select the LANGUAGE.

Press SAVE to confirm or use the back button to return to the SETTINGS menu.

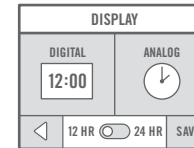

**Display:** Choose DIGITAL or ANALOG DISPLAY. For DIGITAL DISPLAY only, use the toggle to select 12 HR or 24 HR (military).

Press SAVE to confirm or use the back button to return to the SETTINGS menu.

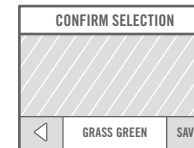
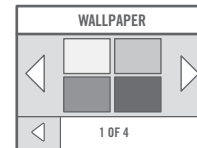

**Wallpaper:** You can customize your Touchscreen color. Simply press a color window to select a WALLPAPER for the home screen.

Press SAVE to CONFIRM SELECTION or use the back button to return to the WALLPAPER menu.